

# **EP 103 - "AGAINST ALL ODDS"**

## **TECH SCOUT - PART ONE**

### **TUESDAY • NOV. 8, 2022**

#### **SET NUMBERS/NAMES:**

- 304 • EXT BALTIMORE STREET
- 307 • EXT WASHINGTON, DC STREET
- 308 • EXT NEWSSTAND/COFFEE TRUCK
- 001 • EXT COLLAR BAR
- 303 • INT BOXING GYM
- 309 • INT IMPORT/EXPORT WAREHOUSE
- 301 • INT BASKETBALL COURT
- 310 • INT INTERROGATION ROOM

**PRODUCTION DESIGNER:** KEVIN BIRD • **ART DIRECTOR:** FELICITY NOVE

**DATE:** 11/08/22

**LOCATIONS:** Paramount Studios (Stages/NY Street/Powerhouse 1) • First Presbyterian Church, 1760 N. Gower St., 90028



SC 51: EXT COLLAR BAR -  
CHARLIE ABDUCTION



SC 14pt, 15pt:  
EXT WASHINGTON, DC ST. -  
EMMA PHONE CALL



SC 12pt: EXT BALTIMORE ST. -  
DAPHNE PHONE CALL



SC 21:  
EXT COFFEE TRUCK -  
EMMA MEETS WITH SINGH



**SETS #:** 304/307/308/001    **SET NAME:** BACKLOT STREET SETS

**DATE:** 11/08/22

**LOCATIONS:** Paramount Studios (NY Street)

THE COMPANY  
**YOU KEEP**

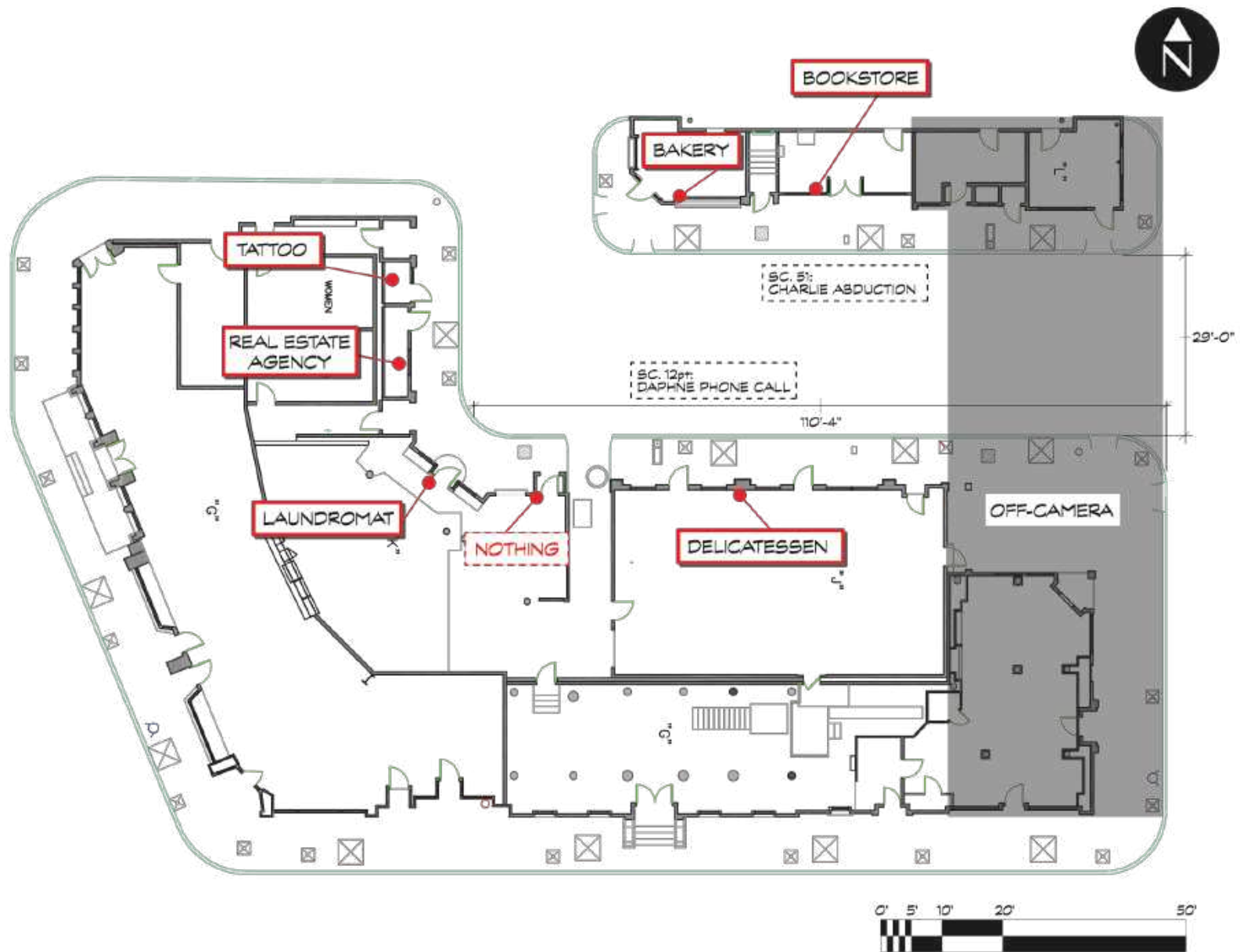

**SET #:** 304/001 **SET NAME:** EXT BALTIMORE STREET/EXT COLLAR BAR

**DATE:** 11/08/22

**LOCATIONS:** Paramount Studios (NY Street)



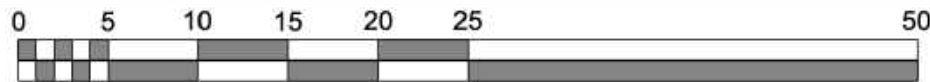
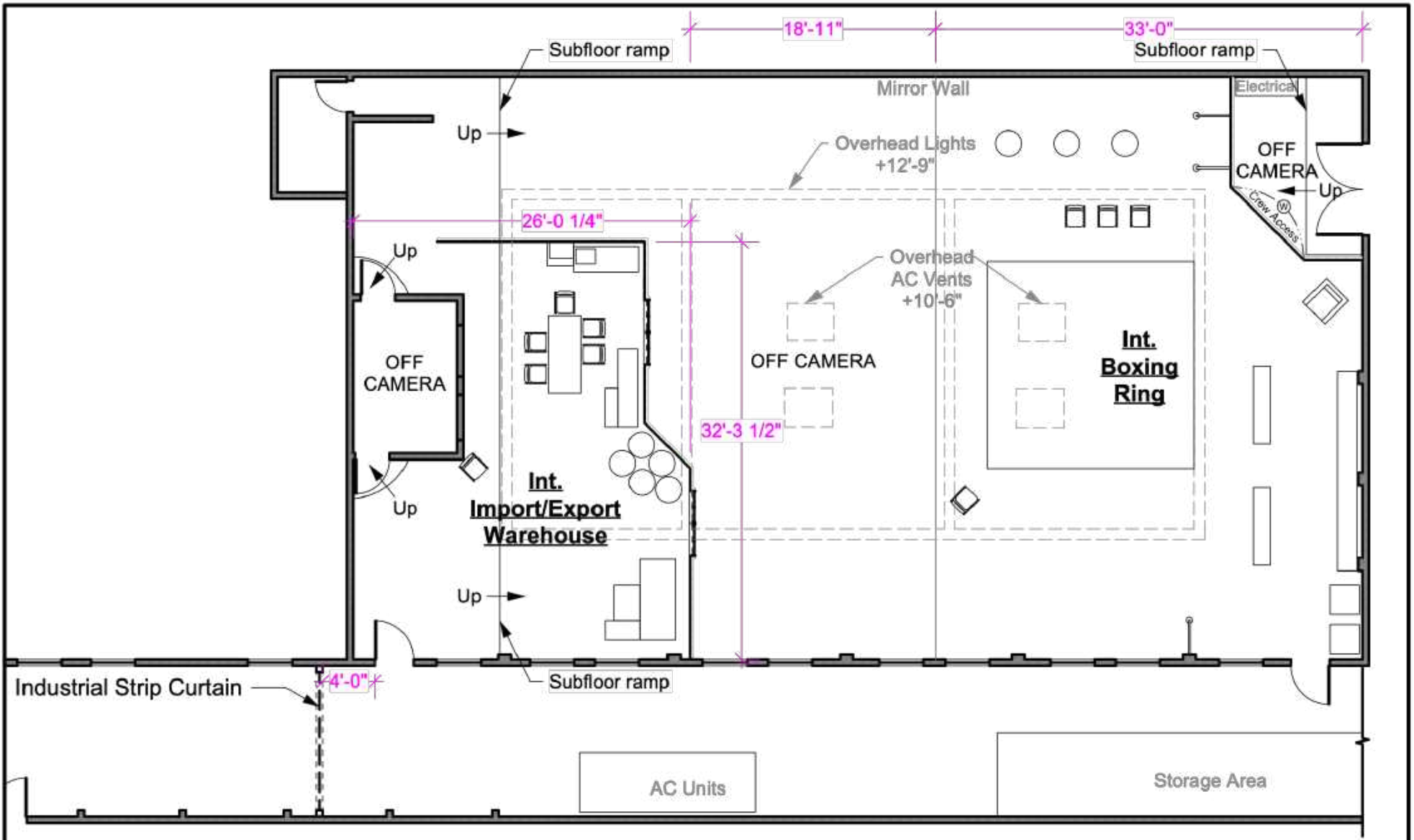

SET #: ---      SET NAME: Power House- Spotting Plan  
 PRODUCTION DESIGNER: KEVIN BIRD      ART DIRECTOR: FELICITY NOVE      SCALE: 3/32" = 1'-0"  
 LOCATION: Paramount Studios Lot - Power House

DATE: 11-04-2022



**SET #:** 303 **SET NAME:** INT BOXING GYM

**LOCATIONS:** Paramount Studios (Powerhouse 1)

**DATE:** 11/08/22

THE COMPANY  
YOU KEEP



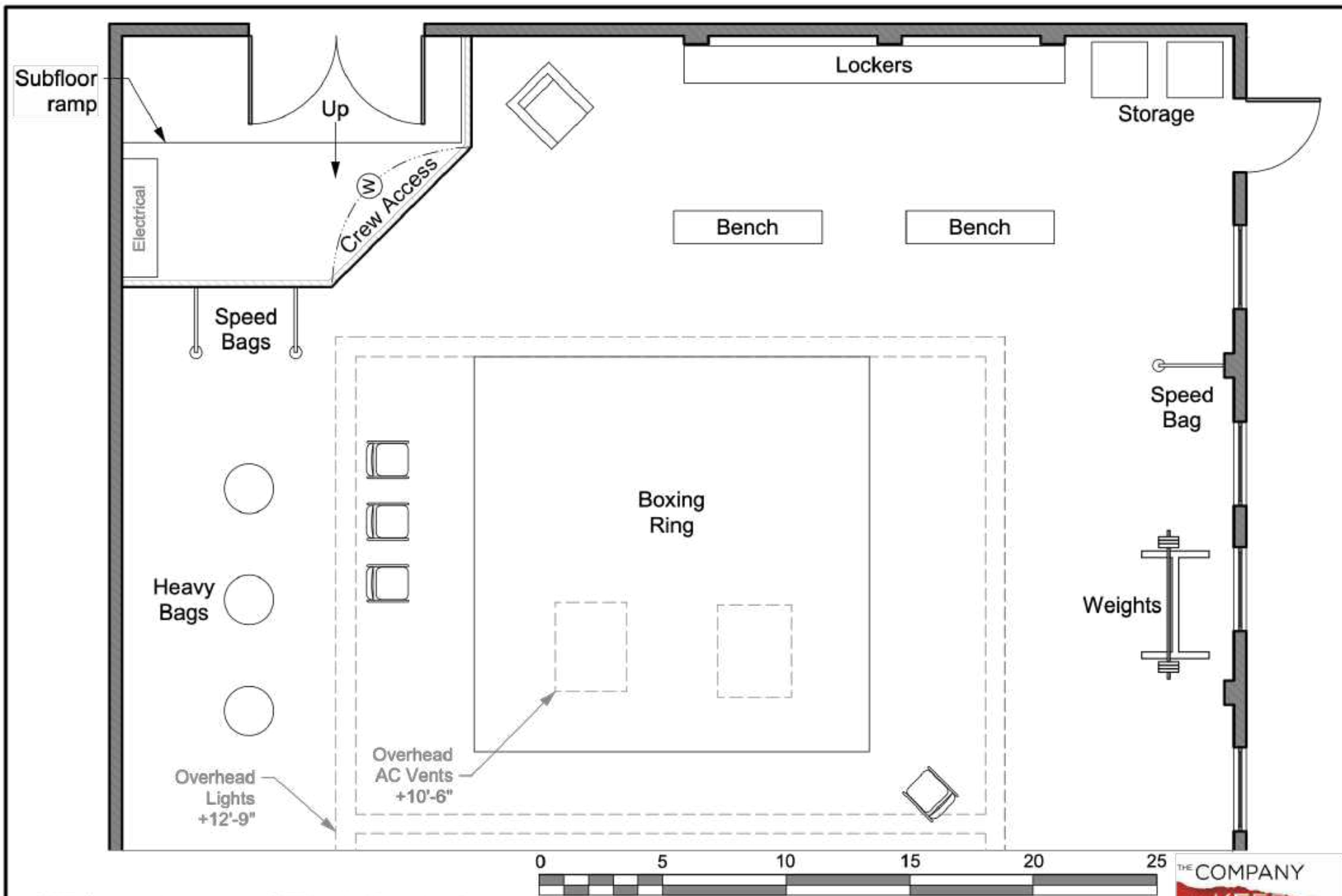

SET #: 203

SET NAME: Int. Boxing Ring

PRODUCTION DESIGNER: KEVIN BIRD

ART DIRECTOR: FELICITY NOVE

SCALE: 3/16" = 1'-0"



LOCATION:

Paramount Studios Lot- Power House

DATE:

11-04-2022



STAGE 4 - PASSAGEWAY



**SET #:** 309 **SET NAME:** INT IMPORT/EXPORT WAREHOUSE

**DATE:** 11/08/22

**LOCATIONS:** Paramount Studios (Powerhouse 1)

THE COMPANY  
YOU KEEP

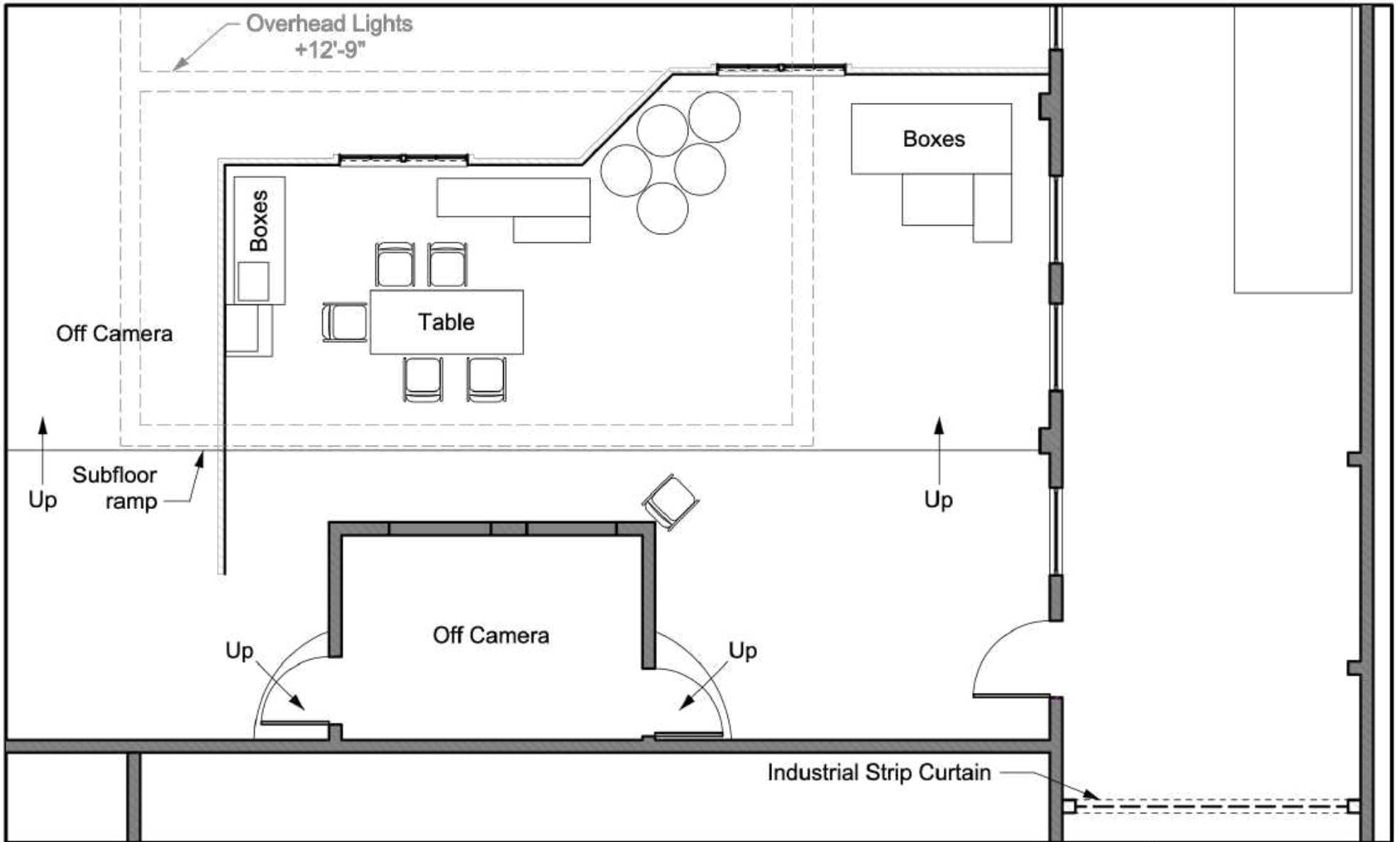

SET #: 309

SET NAME: Int. Import/Export Warehouse

PRODUCTION DESIGNER: KEVIN BIRD

ART DIRECTOR: FELICITY NOVE

SCALE: 3/16" = 1'-0"

LOCATION:

Paramount Studios Lot - Power House

DATE:

11-03-2022



**SET #:** 301 **SET NAME:** INT BASKETBALL COURT

**DATE:** 11/08/22

**LOCATIONS:** First Presbyterian Church, 1760 N. Gower St., Hollywood, 90028



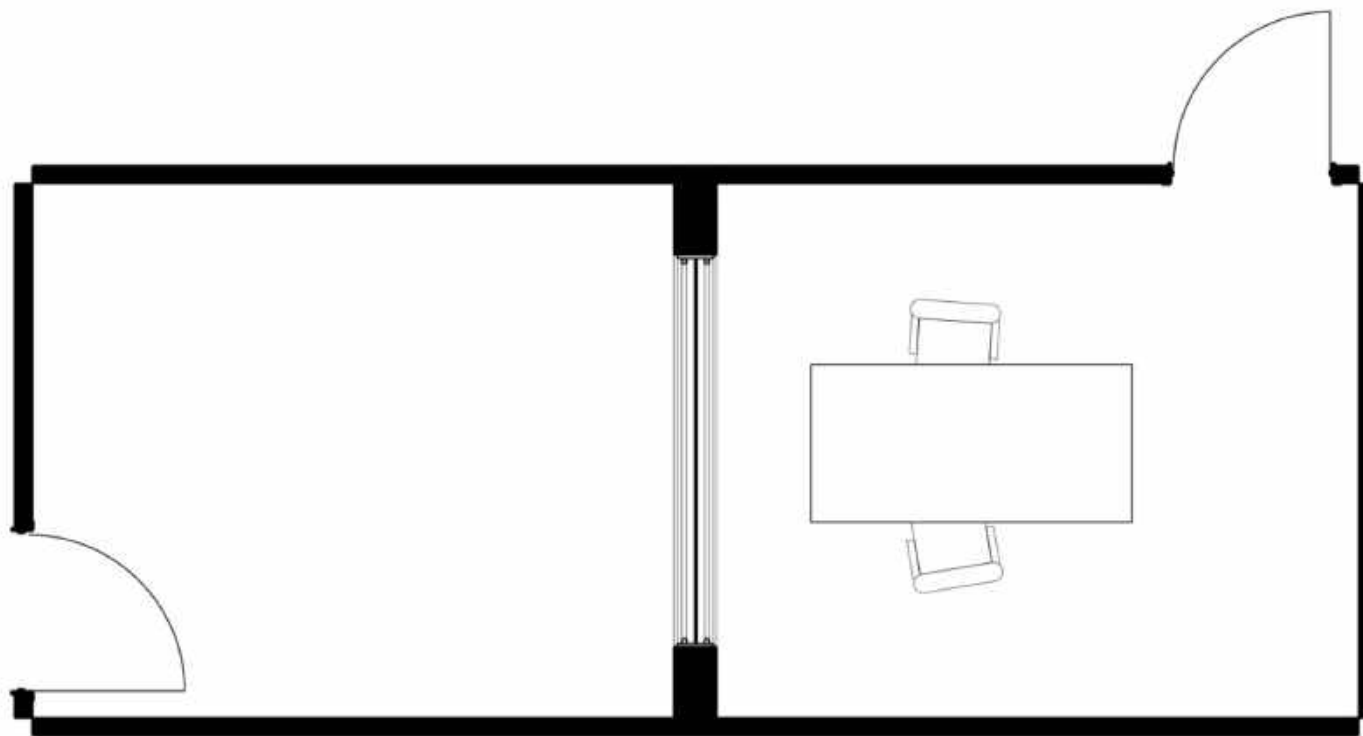

**SET #:** 310 **SET NAME:** INT INTERROGATION ROOM

**DATE:** 11/08/22

**LOCATIONS:** Paramount Studios (Stage 2)



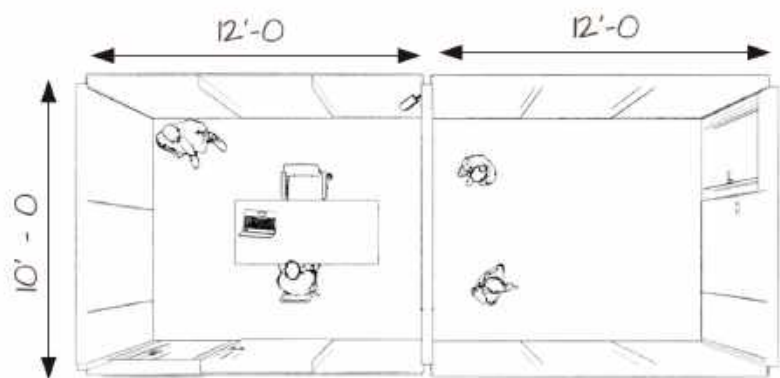

Wall height 7' - 6"



THE COMPANY  
YOU KEEP

INTERROGATION ROOM EP 103/104

# **EP 103 - "AGAINST ALL ODDS"**

## **TECH SCOUT - PART TWO**

### **WEDNESDAY • NOV. 09, 2022**

#### **SET NUMBERS/NAMES:**

305 • I/E HORSE TRACK

313-A • INT JOCKEY CLUB

313-B • INT PATIO RESTAURANT

313-C • INT HORSE TRACK - BATHROOM

313-D • INT HORSE TRACK - BOX

313-E • INT BETTING WINDOW

313-F • INT PASSAGEWAY

313-G • I/E FRONT ENTRANCE/CAB

**PRODUCTION DESIGNER:** KEVIN BIRD • **ART DIRECTOR:** FELICITY NOVE

**DATE:** 11/09/22

**LOCATIONS:** Santa Anita Park - Owners Gate 8, 285 Huntington Drive, Arcadia, 91007



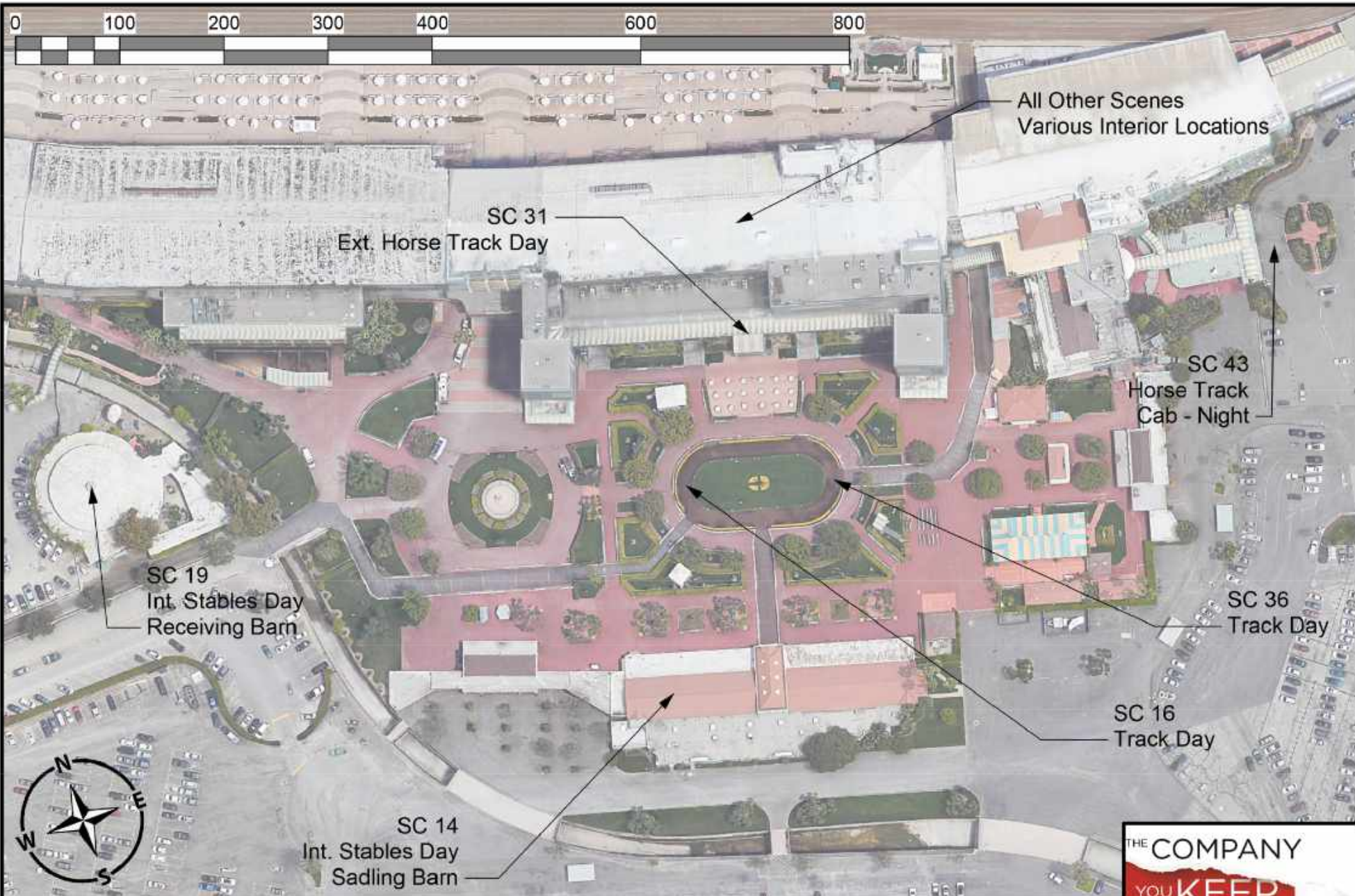

SET #: 305

SET NAME: Int/Ext Horse Track - Site Plan

PRODUCTION DESIGNER: KEVIN BIRD

ART DIRECTOR: FELICITY NOVE

SCALE: 1/128" = 1'-0"

LOCATION: Santa Anita Racetrack-

285 W Huntington Drive  
Arcadia, CA 91007

DATE: 11-07-2022



SCS. 14, 15 - INT STABLES (D)



SC. 16 - EXT HORSE TRACK (D)



SC. 19 - INT STABLES (D)



SCS. 23, 24 - INT JOCKEY CLUB (D)



**SET #:** 305/313-A thru G **SET NAME:** INT HORSE TRACK SETS

**DATE:** 11/09/22

**LOCATIONS:** Santa Anita Park - Owners Gate 8, 285 Huntington Drive, Arcadia, 91007



SCS. 24, 32 - INT PATIO RESTAURANT (D)



SC. 31 - EXT HORSE TRACK (D)



SC. 33 - INT HORSE TRACK (D)



**SET #:** 305/313-A thru G **SET NAME:** INT HORSE TRACK SETS

**DATE:** 11/09/22

**LOCATIONS:** Santa Anita Park - Owners Gate 8, 285 Huntington Drive, Arcadia, 91007



SC. 34 - INT BATHROOM (D)



SC. 35 - INT SPORTS BOOK (D)



SC. 36 - EXT HORSE TRACK (D)



SC. 37 - INT HORSE TRACK BOX (D)



**SET #:** 305/313-A thru G **SET NAME:** INT HORSE TRACK SETS

**DATE:** 11/09/22

**LOCATIONS:** Santa Anita Park - Owners Gate 8, 285 Huntington Drive, Arcadia, 91007



Sc. 38 - INT SPORTS BOOK (D)

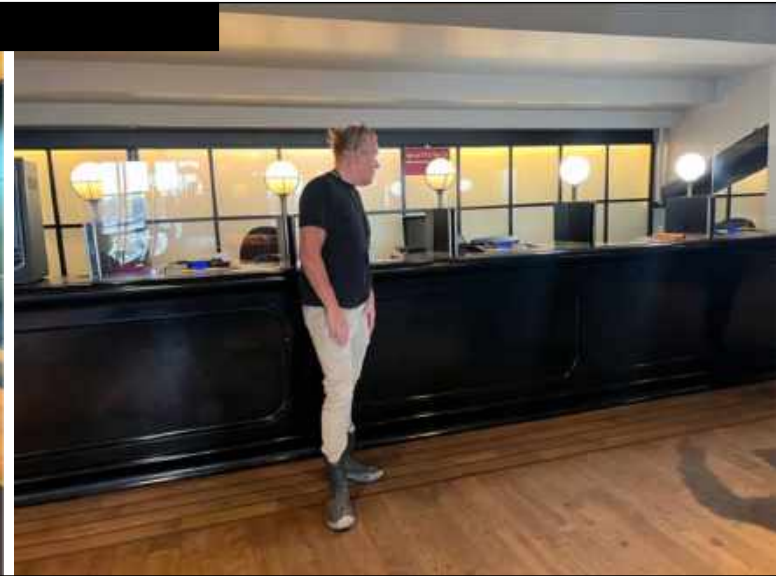

SC. 39 - INT BETTING WINDOW (D)



**SET #:** 305/313-A thru G **SET NAME:** INT HORSE TRACK SETS

**DATE:** 11/09/22

**LOCATIONS:** Santa Anita Park - Owners Gate 8, 285 Huntington Drive, Arcadia, 91007



SC. 43 - EXT HORSE RACE TRACK - CAB (N)



**SET #:** 305/313-A thru G **SET NAME:** INT HORSE TRACK SETS

**DATE:** 11/09/22

**LOCATIONS:** Santa Anita Park - Owners Gate 8, 285 Huntington Drive, Arcadia, 91007

THE COMPANY  
YOU KEEP





**SET #:** 313-D **SET NAME:** INT HORSE TRACK - BOX

**DATE:** 11/09/22

**LOCATIONS:** Santa Anita Park - Owners Gate 8, 285 Huntington Drive, Arcadia, 91007



View of Horse Track

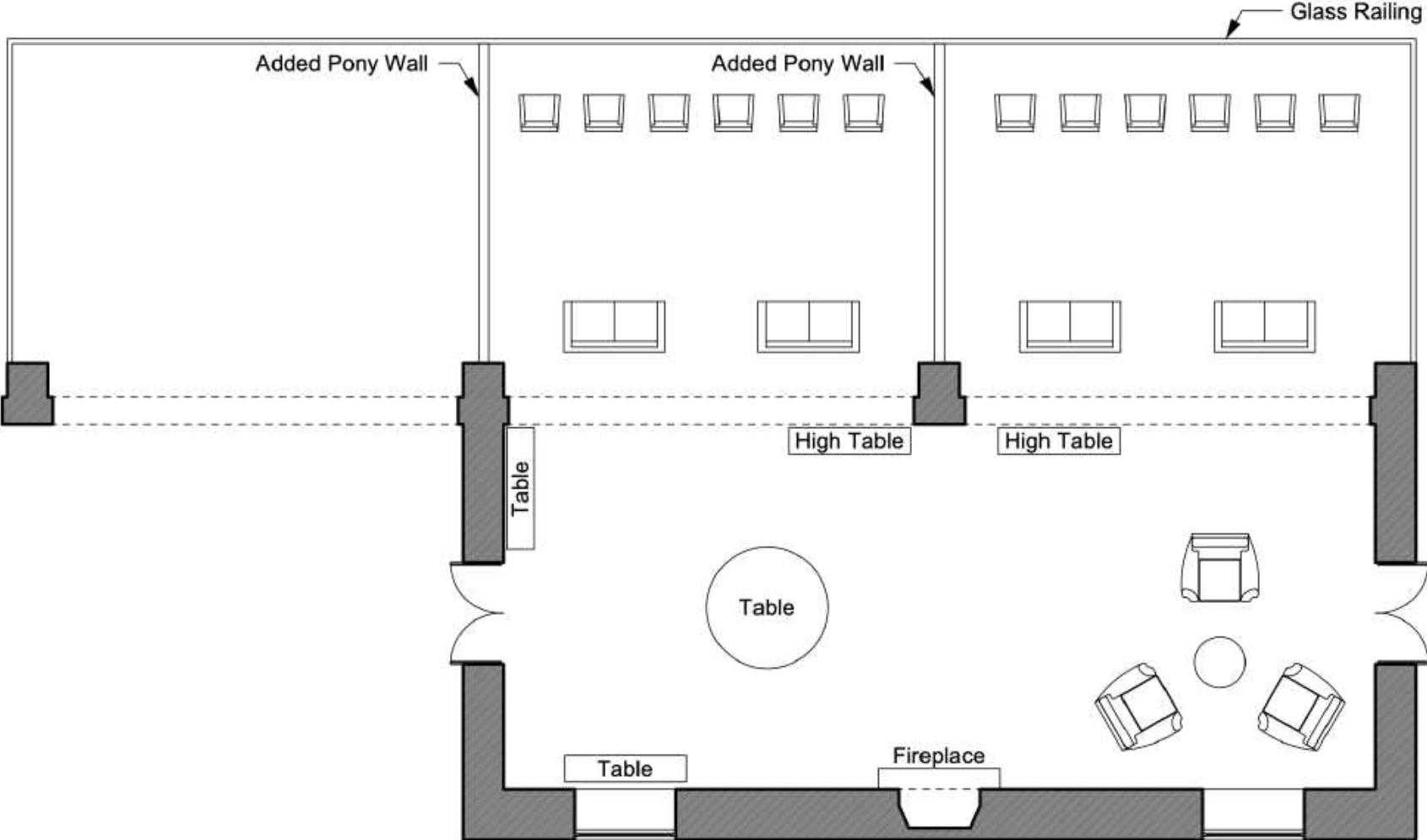

SET #: 305 SET NAME: Int/Ext Horse Track Box  
 PRODUCTION DESIGNER: KEVIN BIRD ART DIRECTOR: FELICITY NOVE SCALE: NOT TO SCALE

LOCATION: Santa Anita Racetrack- 285 W Huntington Drive  
 Arcadia, CA 91007



DATE: 11-07-2022